

7600 P





Smart Sonar™

Smart Sonar™

Automatic rim width acquisition via Smart Sonar™ together with rim diameter and offset measurement via 2D-SAPE make this balancer the ideal solution for high-volume workshops.

Short balancing cycle

Extremely short balancing cycle (start/stop) of 4.5 sec.

easyWEIGHT™

Pinpoint indicator light – an accurate, fast and easy solution to position adhesive weights on the wheel.



easyWEIGHT™

Touch screen

Touch screen monitor with large digits and coloured weight position indicators – improved intuitiveness and ergonomics.

GOLD user interface

This new design of the graphical user interface allows fast and intuitive control of the balancing operation.

Power Clamp™

The patented electro-mechanical Power Clamp™ device clamps the wheel accurately with a constant force, which is most important for every balancing operation.

VPM

Measurement technique for uncompromised accuracy.



Power Clamp™





Rim lighting

Facilitates rim cleaning and speeds up data entry and weight positioning.

QuickBAL™

Only the number of revolutions actually required to get an accurate imbalance measurement is performed, reducing measurement time by 30 %.

Weight tray

New, ergonomic and attractive.



Touch screen

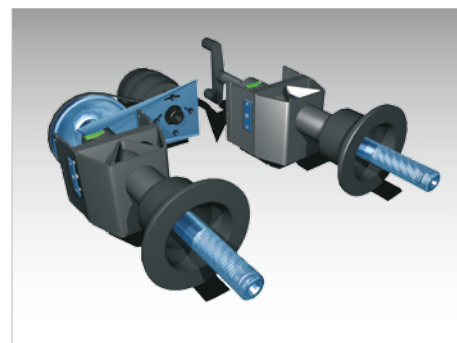

VPM



Stop in position

7600L

- GOLD graphical user interface with touch screen functions
- easyWEIGHT™
- Semi-automatic input of rim diameter and offset with gauge arm
- Automatic input of rim width via Smart Sonar™
- easyALU™
- Rim lighting
- VPM measurement technique
- Constant rotational speed
- QuickBAL™ for reduced balancing times
- Imbalance minimisation program
- Imbalance optimisation program
- Split weight mode
- The pedal-operated mechanical lock firmly holds the wheel in every position
- Wheel clamped on the integrated flange by means of a quick nut
- Oversize shaft



Power Clamp™ device,
Stop-in-position feature and
electro-mechanical lock



GOLD graphical user interface with touch screen functions

Time-saving and intuitive user interface.

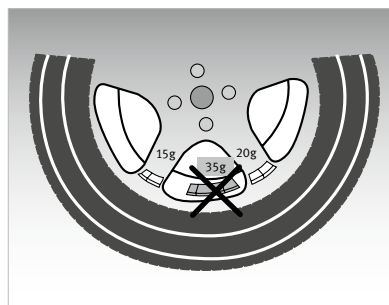

Split weight mode

Hides adhesive weights behind two adjacent spokes so they cannot be seen from the outside.

7600L

- Combined with the optional wheel lift BW 2010 this wheel balancer with Power Clamp™ device is highly ergonomic.
- While the wheel lift facilitates loading of heavy car wheels, the Power Clamp™ device guarantees absolutely correct centring and clamping of the wheel which is essential for every balancing operation.
- The additional Stop-in-position feature expedites operation even more: the operator only has to touch the amount of unbalance on the screen and the wheel is automatically indexed to correction position.

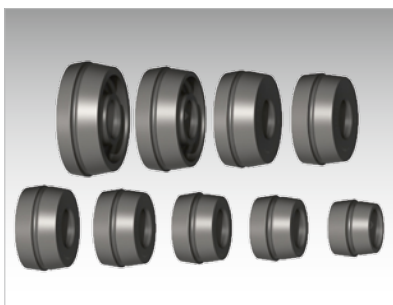

Centring means

A vast range of centring means helps to achieve most accurate results for the high variety of wheels available in the market.



Stop-in-position

Touching the amount of unbalance on the screen automatically gets the wheel indexed to correction position.